

FILTER SCREEN 4430-001 FOR HIGH PRESSURE JET POWER PUMPS

TO REPLACE FILTER SCREEN

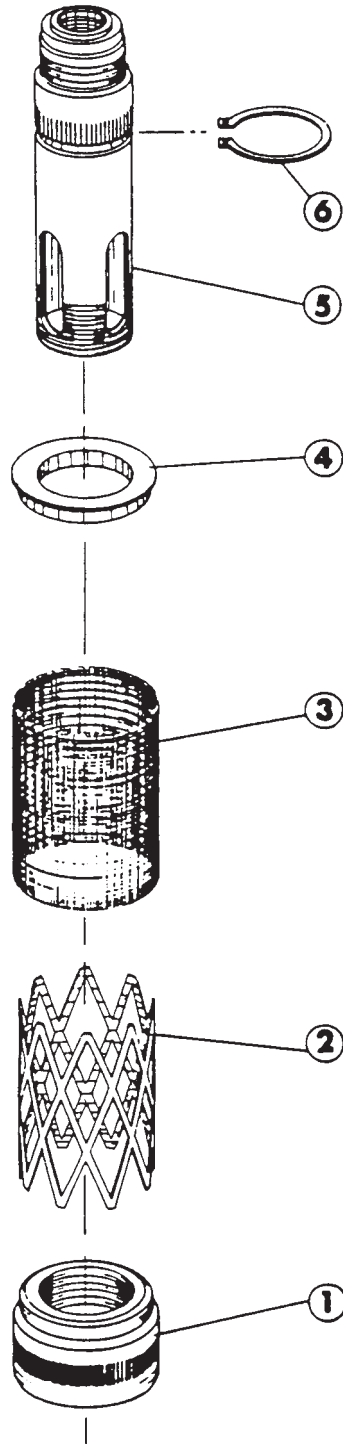

NOTE: Usually the only pieces which will need replacing are the screen (3) and the screen support (2). Both pieces should be replaced together at the same time.

1. Remove bottom screen collar (1), screen (3) and screen support (2) from pump.
2. Place screen support (2) inside screen (3) and place on screen collar bottom (1).
3. Securely tighten screen assembly on primer cylinder (5).

TO REPLACE PREVIOUS DESIGN ONE-PIECE SCREEN

1. Remove filter screen 811713 (44890) from pump.
 2. Remove nut 806467 (27829) and primer piston 807410 (33978) from bottom of pump.
 3. Remove primer cylinder 807412 (33979) from pump.
 4. Secure new primer cylinder (5) to pump.
 5. Assemble primer piston 807410 (33978) and secure to pump with nut 806467 (27829).
 6. Place screen support (2) inside screen (3) and place on screen collar bottom (1).
 7. Place top collar (4) on top of screen (3).
 8. Attach retaining ring (6) to primer cylinder (5).
- NOTE:** If follower plate is used, omit use of retaining ring and slip O-ring seal 806899 (32731-18) over primer cylinder (5) against guide tube.
9. Securely tighten screen assembly on primer cylinder (5).

ITEM	PART NO.	DESCRIPTION
1	813382	Bottom .Screen Collar
2	813380	Support, Screen
3	807415	Screen*
4	813378	Top, Screen Collar
5		Not included in kit**
6	820836	Retaining Ring

***NOTE:** 12 mesh Screen 813379 is available for extra heavy grease when needed in place of 807415 screen.

****NOTE:** If needed order part number 832100