

Grease Piston Pumps Panther® HP 50:1 Pumps

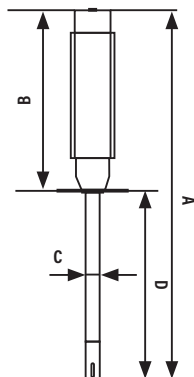

Dimensions inches (MM)			
1150-009			
A	B	C	D
36.75" (933 mm)	18.75" (476 mm)	1.25" (31.75 mm)	18" (457 mm)
1150-010			
46.75" (1187 mm)	18.75" (476 mm)	1.25" (31.75 mm)	28" (711 mm)
1150-011			
52.75" (1340 mm)	18.75" (476 mm)	1.25" (31.75 mm)	34" (834 mm)

TECHNICAL DATA	
Pump ratio	50:1
Continuous duty free flow	2 lb/min
Cycles per lb @ 100 psi (7 bar) free flow	70
Pump delivery with NLGI-2, 75° F (23.8° C), 100 psi (7 bar) air pressure and free flow	3.4 lb/min (1.54 kg/min)
Operating air pressure range	40-150 psi (2.8-10 bar)
Max fluid stall pressure @ 150 psi (10 bar) air	7500 psi (517 bar)
Effective Air Piston Diameter	2 1/2" (63.5 mm)
Air motor stroke	3.25" (83 mm)
Air consumption 100 psi (7 bar) & 1.5 lb/min (.68 kg/min)	14.5 SCFM
Air inlet	1/4" NPT(F)
Fluid outlet	1/4" NPT(F)
Wetted materials	Stainless Steel, Carbon Steel, Brass, Aluminum, Delrin®, Ultrathane®, and Buna-N™
Noise	92 dB
Service Bulletin	SB 1063

NOTE: Pumping distance and pipe diameter will effect dispensing performance.

Warning! Do not use any Pride series products with flammable fluids.

Verify fluid compatibility with MSDS sheets.

Contact Balcrank for pumping grease higher than NLGI-2 and specific system design performance technical data.

Grease up to NLGI-2

Designed for lower volume users up to 2 dispense points. Designed for 25-35, 120, and 400 lb. drums. Ideal for lower volume grease fittings on trucks and farm implements. Panther® pump is a double acting positive displacement capable of delivering up to 3.4 lbs. (1.54 kg) per minute.

Applications

- Roll-around unit for small vehicle grease points
- Agriculture/farm implements
- Small auto/truck shops
- Tire & transmission shops
- In-plant low volume use

MODELS AVAILABLE	DESCRIPTION
1150-009	Panther® HP 50:1 bare 25-35 lbs
1150-010	Panther® HP 50:1 bare 120 lbs
1150-011	Panther® HP 50:1 bare 400 lbs

