

# Oil Piston Pumps

## Lion™ 450 - 10:1 Pumps

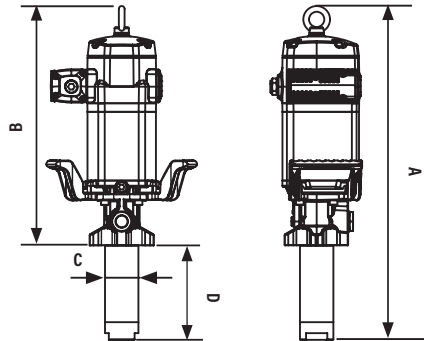

DIMENSIONS INCHES (MM)			
<b>1430-003</b>			
A	B	C	D
28" (702 mm)	20" (502 mm)	2" (54 mm)	8" (200 mm)
<b>1430-004</b>			
56 1/4" (1,430 mm)	19 7/8" (505 mm)	2 1/8" (54 mm)	36 13/32" (925 mm)

TECHNICAL DATA	
Operating air pressure	30 to 180 psi (2 to 12.4 bar)
Cycles per gallon	19
Air Consumption <sup>(1)</sup>	30 cfm (850 NI/min)
Max fluid outlet pressure <sup>(3)</sup>	1,700 psi (120 bar)
Air motor effective diameter	4.5" (115 mm)
Air motor stroke	4" (100 mm)
Delivery at 80 cpm	4 gal/min (15 l/min)
Max free flow delivery	18 gal/min (68 l/min)
Air inlet	1/2" NPT(F)
Fluid inlet	1 1/2" NPT(F)
Fluid outlet	3/4" NPT(F)
Wetted materials	Cast iron, hard chromed steel, steel, polyurethane Buna-N™ and zinc
Noise level <sup>(2)</sup>	80 dB
Service Bulletin	SB 1136

- (1) Maximum air consumption with 75 psi (5 bar) air inlet pressure and 80 cpm.  
 (2) Maximum noise level measured at 3' (1 m) from the pump, 100 psi (7 bar) air pressure and free delivery.  
 (3) Ensure that all hose fittings and piping are rated for fluid outlet pressures. Balcrank recommends a minimum of 3 x safety factor.

NOTE: Thermal expansion of the fluid in a distribution system can cause an increase in system pressure that can damage lubrication system components. Use pressure relief valve kit included with this pump.

**Warning!** Do not use any Lion™ 450/600 series products with flammable fluids. Verify fluid compatibility with MSDS sheets.

Contact Balcrank for specific system design performance and technical data.

## Fluids & Applications

1

High pressure pump for oil systems where medium volume dispensing using simultaneous dispense points is required. High pressure pump is recommended for long pumping distances and/or cold weather applications.

### Fluids

- Synthetic and mineral based lubricants
- Hydraulic fluid
- Gear oil
- Transmission fluid

### Applications

- Heavy duty truck/fleet
- Railroad/mass transit vehicle maintenance
- In-plant high volume transfer
- Marine
- Mining vehicle maintenance
- Large automotive dealerships

**Pressure relief valve kit included with this pump.**

**Pump bung is mountable using 4411-032**

MODELS AVAILABLE	DESCRIPTION
<b>1430-003</b>	Lion™ 450 10:1 stub pump
<b>1430-004</b>	Lion™ 450 10:1 drum pump

### TEST FLUID: SAE 10

