

Balcrank®

Premium Series Grease Dispensing Booster Handle

Models:

Handle Only

3310-007

Handle w/Swivel

3310-009

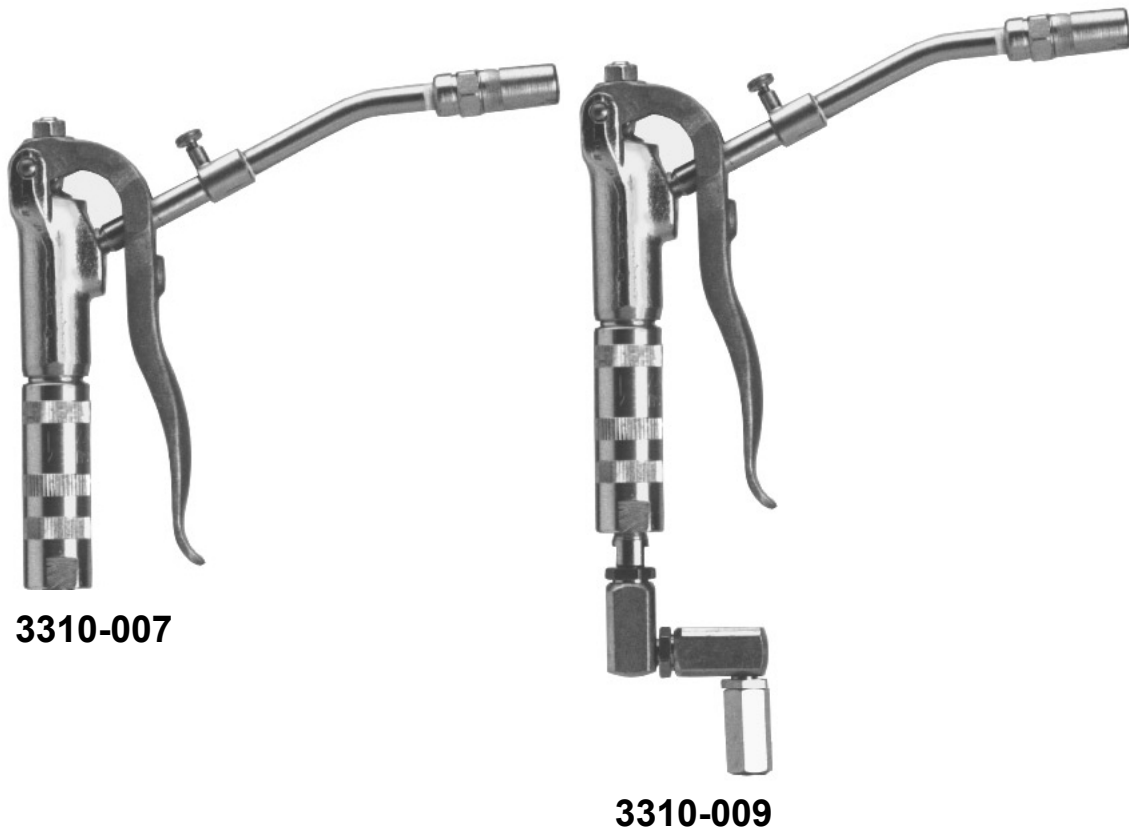

Thoroughly read and understand this manual before installing, operating or servicing this equipment.

**OPERATION, INSTALLATION,
MAINTENANCE AND REPAIR GUIDE**

General Safety

Thoroughly read and understand this manual before installing, operating or servicing this equipment.

Guide to Safety Comments:

NOTE: Gives more explanation of a procedure, or a helpful hint.



CAUTION: Alerts user to avoid or correct a condition which may or could cause damage and/or destroy the equipment.



WARNING: Alerts user to avoid or correct conditions which could cause bodily injury.

Because this Grease Control Handle can be incorporated into pressurized systems, the following safety precautions should be observed:

- Check equipment regularly and repair or replace worn and damaged parts.
- Release pressures built up in the system before any service or repair is begun. See *pressure relief procedure*.
- Never alter or modify any parts of this product; doing so may cause damage and/or personal injury.
- Never aim a dispensing valve at any person. Personal injury may result.
- Do not operate this product above 5000 PSI (345 BAR) grease supply pressure.
- Always read and follow fluid manufacturers' recommendations regarding proper use of protective eyewear, clothing and respirators.
- Observe all limitations which apply to selection of fluids which may be pumped by this product.



WARNING: Fluid emitted under high pressure from leaks and/or ruptured components can penetrate the skin and cause extremely serious bodily injury. If any fluid appears to penetrate the skin, apply emergency medical care at once. Do not treat the penetration as a simple cut. Tell your physician exactly what type of fluid was injected into your skin.



WARNING: Do not place your hand or fingers over the dispensing nozzle and/or aim the nozzle at a person at any time. Personal injury may result.



WARNING: Always use the following **Pressure Relief Procedure** whenever shutting off, cleaning, or in any way checking or servicing the control handle:

- (1) Disconnect air at the supply pump.
- (2) Point control handle outlet away from yourself and others.
- (3) Open dispensing valve until pressure is relieved.
- (4) Leave any bleed-type drain valves open until you are ready to use the system again.



WARNING: Never attempt to force lubricant into a fitting! If the lubricant is not flowing, stop dispensing immediately. Forcing lubricant into a fitting may cause excessive back pressure in the flexible extension. High back pressure could cause the extension and/or other components of the system to rupture, causing serious bodily injury.



WARNING: High Pressure. Keep clear of nozzle. 7,500 psi maximum inlet pressure

TABLE OF CONTENTS

Cover.....	1
General Safety Information.....	2
Operation and Repair Procedures.....	3
Troubleshooting.....	4
Parts Diagram & List.....	5
Notes.....	6 & 7
Warranty.....	8

OPERATION

The **Premium Booster Series** High Pressure Control Handle is designed for use as a standard control handle and as a “Booster” when extreme pressures are required. A single shot of lubricant is delivered when the trigger is pulled from the forward position and then immediately released. A continuous flow of lubricant is delivered when the trigger is pulled from the forward position and held against the body of the handle. When higher pressures are required, just squeeze or pump the trigger as needed up to approximately ten times to increase pressure up to 10,000 psi.

 **WARNING:** Due to extensive pressures developed when the trigger is pumped repeatedly, it may be necessary to open bleeder valve before removing coupling from fitting.

NOTE: Clean all parts thoroughly when disassembling. Check the parts carefully and replace worn or damaged parts.

Lubricant Flow Adjustment (Two Piece Body Style Only)



Refer to product illustrations, page 6. Loosen the locking nut (13), then turn the adjusting screw (12) in or out to obtain the best trigger position. Lock the adjustment by tightening the nut (13).



WARNING: ALWAYS follow pressure relief procedure (page 2) before servicing or disassembly.

Repair Procedures

Refer to illustrations and parts list, page 6.

Control Handle Disassembly

- Review warnings. (page 2)
- Disconnect the high pressure handle from the the supply hose.
- Place the control handle in a bench vise, with the vise gripping the control handle body (22).
- Using an adjustable open end wrench, unscrew and remove the z-swivel (28).
- Remove the Inlet screen assembly (26) & (27) from the hand grip (25).
- Using a small pipe wrench, unscrew and remove the extension tube and booster adapter body (2) & (3).
- Using a mallet and pin, remove the trigger pin (14). Remove the trigger subassembly (24), (12), (13) and set aside.
- Using pliers, remove the valve plunger (18). Using a screwdriver, unscrew and remove the packing nut (15). Remove the packing seal (16).
- Using a strap wrench, unscrew and remove the hand grip (25).
- Remove from body and hand grip cavities, Gasket (17), ball (19), plunger spring (23), ball seat (20) and a second ball (19).
- If needed, disassemble parts from the trigger (24). Using a screwdriver and an open end wrench, remove the set screw (12) and hex nut (13).
- Remove spring retainer (8) from booster adapter (3). Then Remove booster spring (6) and ball (9).

Control Handle Assembly

- Follow the control handle disassembly procedures (previous page) in reverse.

REMINDER: Clean all parts thoroughly before reassembling. Check the parts carefully and replace worn or damaged parts.

Trouble Diagnosis and Remedy

TROUBLE	PROBABLE CAUSES	REMEDY
<p>Grease continues to flow after the trigger is released.</p>	<ul style="list-style-type: none"> • Valve may be out of adjustment. • Valve balls or seat may be worn or obstructed, or spring may be weakened. 	<p>Adjust trigger travel by loosening the hexnut (13) and turning the set screw (12) in or out as needed. Holding the set screw (12) in place, securely tighten the hex nut (13).</p> <p>Unscrew the lower body (25) from the upper body (22). Remove and inspect/replace balls (19), valve spring (23), gasket (17) ball seat (20).</p>
<p>No flow or very little flow.</p>	<ul style="list-style-type: none"> • Screen in lower body may be dirty. 	<p>Remove the swivel assembly (28) from the lower body (25). Then remove the brace - spring and screen (26) and screen (27). Thoroughly clean screen in a non-flammable solvent.</p>
<p>Grease leaks around valve stem.</p>	<ul style="list-style-type: none"> • Valve stem or U-packing may be worn or damaged. 	<p>Remove both extension tubes (2) & (3). Remove trigger pin (14) and trigger assembly (24). Remove packing screw (15), U-packing (16), and valve plunger (18). Inspect and replace as needed.</p>
<p>Grease is leaking from swivel assembly.</p>	<ul style="list-style-type: none"> • Swivel packing may need to be tightened. • Swivel packing have failed. 	<p>Adjust collar/retaining nut. Tighten collar/retaining nut (29) approximately 1/8" of a turn at a time and check for leaks again</p> <p>Replace swivel assembly.</p>
<p>Handle will not build pressure.</p>	<ul style="list-style-type: none"> • Ball seat of spring in the extension adapter is worn or damaged. 	<p>Remove extension tubes (2) & (3). Wash extension tube assembly (3) to remove grease from inside the adapter. Remove spring retainer (8), spring (6) and ball (9), Inspect and replace as needed.</p>

PARTS DIAGRAM
Models 3310-007 & 3310-009

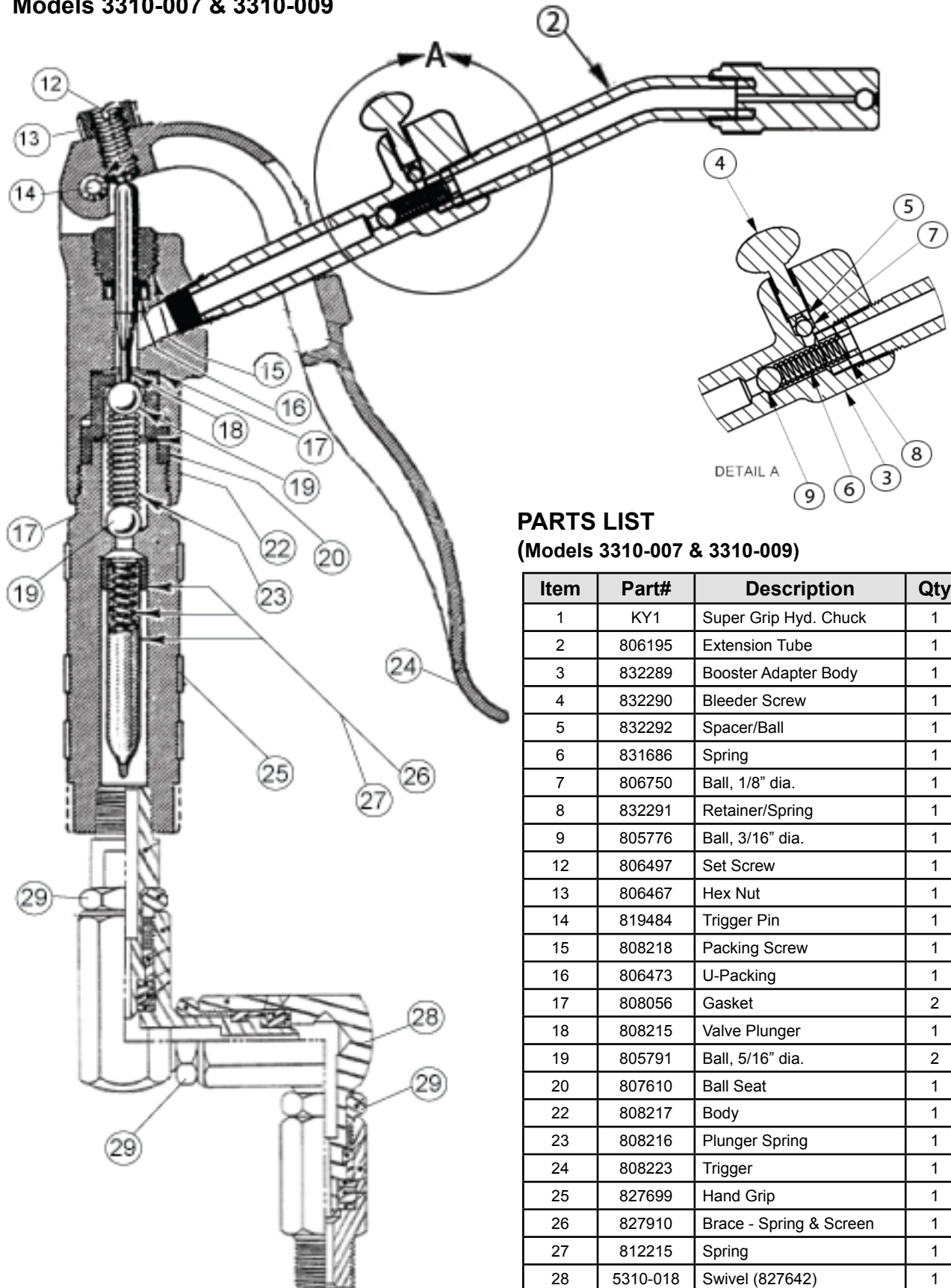

PARTS LIST
(Models 3310-007 & 3310-009)

Item	Part#	Description	Qty
1	KY1	Super Grip Hyd. Chuck	1
2	806195	Extension Tube	1
3	832289	Booster Adapter Body	1
4	832290	Bleeder Screw	1
5	832292	Spacer/Ball	1
6	831686	Spring	1
7	806750	Ball, 1/8" dia.	1
8	832291	Retainer/Spring	1
9	805776	Ball, 3/16" dia.	1
12	806497	Set Screw	1
13	806467	Hex Nut	1
14	819484	Trigger Pin	1
15	808218	Packing Screw	1
16	806473	U-Packing	1
17	808056	Gasket	2
18	808215	Valve Plunger	1
19	805791	Ball, 5/16" dia.	2
20	807610	Ball Seat	1
22	808217	Body	1
23	808216	Plunger Spring	1
24	808223	Trigger	1
25	827699	Hand Grip	1
26	827910	Brace - Spring & Screen	1
27	812215	Spring	1
28	5310-018	Swivel (827642)	1
29		Collar/Retaining Nut	3

Balcrank Lubrication Equipment Warranty Statement

All Balcrank equipment sold by authorized Balcrank distributors is warranted to their original customer to be free from defects in materials and workmanship for a period of one year from the date of sale to that customer. Selected Balcrank equipment carries warranty terms for a more extended period as defined in the Balcrank Lubrication Equipment & Accessories User Price List, wherein a "lifetime" warranty represents a warranty period of thirty years. Within the initial one-year warranty period, Balcrank will repair or replace all Balcrank equipment determined by Balcrank to have defective materials or workmanship. For equipment carrying more extended warranties, Balcrank will repair or replace the product including parts and labor during the first full year and will provide parts only for the remainder of the warranty period.

This warranty applies only to equipment installed and operated according to applicable Balcrank Service Bulletins and Installation Instructions.

Any equipment claimed to be defective must be returned, freight prepaid, to an Authorized Balcrank Service Center (ASC). Upon receiving candidate warranty equipment from a customer, ASC will: 1) diagnose to determine the warrantable condition of the equipment, 2) submit, prior to repair or replacement, a request to Balcrank for warranty authorization, then 3) in cooperation with Balcrank, proceed with repair locally or forward the equipment to Balcrank and obtain replacement. If the part(s) or equipment items are found defective upon inspection by Balcrank, they will be repaired or replaced, and then will be returned to the ASC. If Balcrank finds the claimed part(s) or equipment not to be defective, the ASC will receive written authorization from the original customer, and then repair them for a reasonable charge to the customer, which will include all applicable parts, labor, and return transportation costs.

Optionally, the customer may submit certain eligible products directly to Balcrank for warranty return by using Balcrank Lubrication Equipment Direct Service Warranty Procedure. Eligible products are defined in the Balcrank Lubrication Equipment & Accessories User Price List. Refer to the Balcrank web site www.balcrank.com for a copy.

Any equipment returned to Balcrank must have the Warranty Service Claim number (WSC#) clearly marked on the outside of the carton. Balcrank's sole responsibility is for defects in material and workmanship, and Buyer's sole and exclusive remedy hereunder, shall be limited to repair or replacement of the defective part or equipment.

This warranty does not cover, nor shall Balcrank be liable for repair or replacement of parts or equipment resulting from general wear and tear through use, or damage or failure caused by improper installation, abuse, misapplication, abrasion, corrosion, insufficient or improper maintenance, negligence, accident, alteration, or substitution of non-Balcrank parts.

Furthermore, the Warranty for Lubrication Equipment and Accessories does not cover the following specific conditions:

- Failure or damage to equipment caused by dirt or debris in compressed air lines and fluid lines. This includes, but is not limited to, clogged inlet filters, strainers, or regulators; fluid meters; control handles; fluid tips; and valves.
- Failure of normal wear parts including but not limited to: o-rings, packings, seals and valves unless originally improperly installed by the factory.
- Products placed in applications for which their use was not intended. Examples include but are not limited to Lubricant pump being used to pump solvents, or placing equipment intended strictly for indoor use outdoors
- Damage to equipment resulting from operation above and beyond Balcrank's recommendations.
- Leaks at air and fluid fittings and connections.
- Damage caused by thermal expansion whenever adequate pressure relief was not included in the system.
- Loose suction tubes on pumps.
- Incorrect hose reel spring tension, requiring adjustment.

THERE ARE NO OTHER WARRANTIES, EXPRESSED OR IMPLIED, INCLUDING WARRANTIES OF MERCHANTABILITY OR FITNESS FOR A PARTICULAR PURPOSE. IN NO EVENT SHALL BALCRANK BE LIABLE FOR ANY SPECIAL, CONSEQUENTIAL, OR OTHER DAMAGES OF SIMILAR NATURE, INCLUDING BUT NOT LIMITED TO LOST PROFITS, LOST PRODUCTION, PROPERTY DAMAGE, PERSONAL INJURY, WHETHER SUFFERED BY BUYER OR ANY THIRD PARTY, IRRESPECTIVE OF WHETHER CLAIMS OR ACTIONS, LEGAL OR EQUITABLE, FOR SUCH DAMAGES ARE BASED UPON CONTRACTS, WARRANTY, NEGLIGENCE, STRICT LIABILITY, OR OTHERWISE. ANY CLAIM OR ACTION FOR BREACH OF WARRANTY MUST BE BROUGHT WITHIN TWO (2) YEARS FROM THE DATE OF SALE TO THE ORIGINAL CUSTOMER.

Balcrank® Corporation
Weaverville, NC 28787
800-747-5300
800-763-0840 Fax
www.balcrank.com

SERVICE BULLETIN SB 3006
Rev. B 10/07
822033

Revision Log:
Rev. A - release handle body.
Rev. B - add new booster extension parts