

SERVICE BULLETIN SB 3105
Rev. A 04/16

Balcrank[®]

Light Fluid Control Handle

Model 3320-055

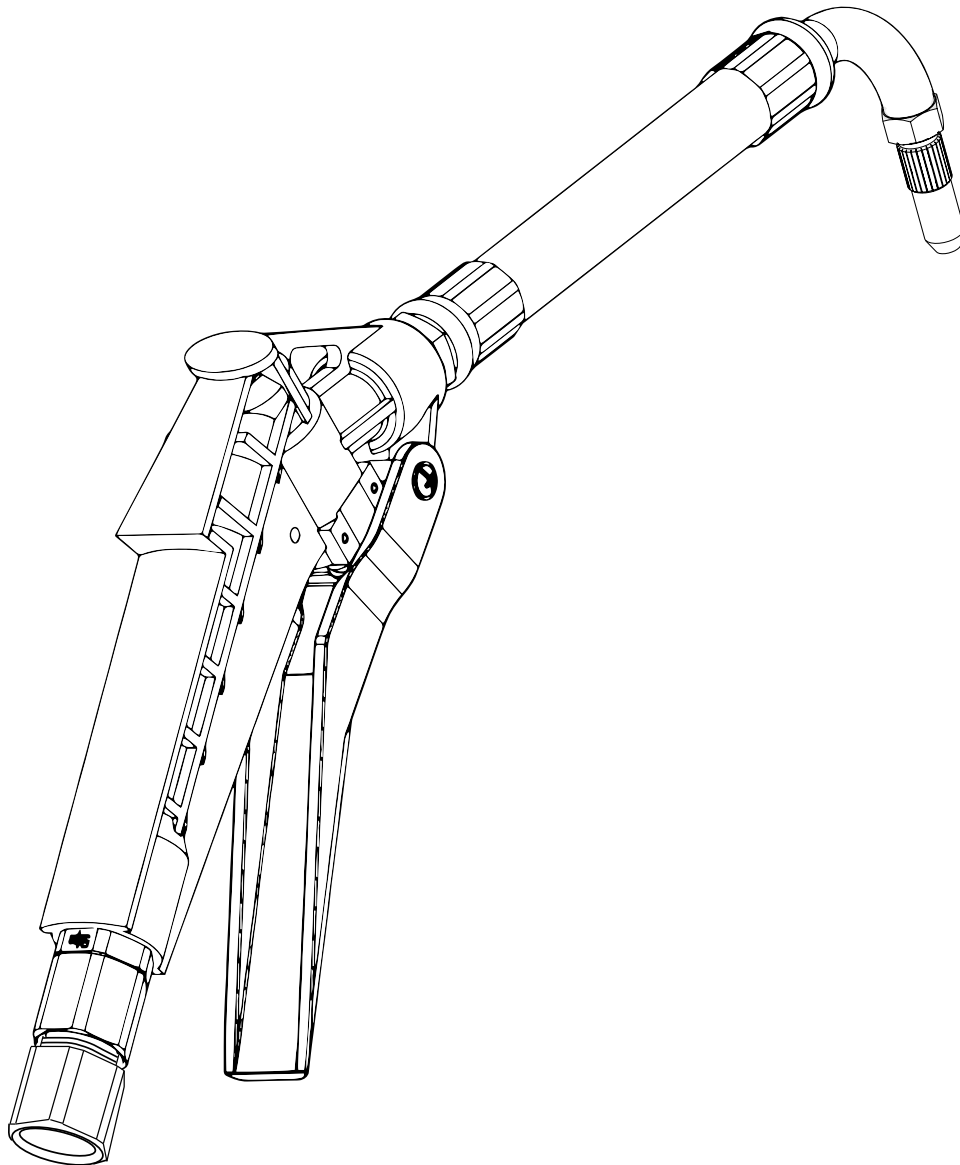

Thoroughly read and understand this manual before installing, operating or servicing this equipment.

Operation, Installation,
Maintenance and Repair Guide

GENERAL SAFETY

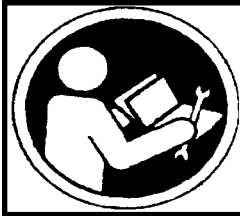

IMPORTANT

Read these safety warnings and instructions in this manual completely, before installation and start up of the control handle. It is the responsibility

of the purchaser to retain this manual for reference. Failure to comply with the recommendations stated in this manual will damage the control handle and void factory warranty.



WARNING

Airborne particles and loud noise hazards.

Wear ear and eye protection.



CAUTION

- 1) Always read and follow the fluid manufacturers's recommendations regarding the use of protective eye wear, clothing, gloves, and other personal equipment.
- 2) Never alter or modify any parts of this product; doing so may cause damage and/or personal injury.



CAUTION

Maximum Fluid Pressure 580 PSI (40 bar). Under no circumstances should the control handle be aimed at any person or your own body at anytime. Personal injury may result.



WARNING

DANGER: Not for use with fluids that have a flash point below 100°F (38°C, examples: gasoline, alcohol). Sparking could result in an explosion which could result in death.



WARNING

Always use the following Pressure Relief Procedure whenever shutting off, cleaning, or in any way checking or servicing the control handle:

- 1) Disconnect compressed air line or turn off power supply at the fluid pump.
- 2) Point the control handle outlet into a waste container and open trigger to relieve pressure.
- 3) Open any bleed-type supply air valves and fluid drain valves in the system.
- 4) Leave the drain valves open until you are ready to re-pressurize the system.



WARNING

Do not place your hand or fingers over the dispensing nozzle and/or aim the nozzle at a person at any time. Personal injury may result.

TABLE OF CONTENTS

Cover.....	1
General Safety.....	2
Product Description.....	2
Technical Specifications.....	2
Installation & Operation.....	3
Troubleshooting.....	3
Parts List.....	3
Warranty Information.....	Back Cover

PRODUCT DESCRIPTION

Fluid control handle for antifreeze, windshield wash solution, and water. Made of high resistant thermoplastic, with a trigger regulated valve, which allows optimal control of fluid delivery. Ergonomic grip with 1/2" NPT (F) inlet swivel, and flex 90 1/4 turn manual tip.

TECHNICAL SPECIFICATIONS

Maximum Delivery.....	4 Gal/min (15 l/min)
Max working pressure	580 psi (40bar)
Max working temperature	122°F (50°C)
Inlet thread.....	1/2" NPT(F)
Weight.....	1.5 lbs (0.7 kg)
Fluid compatibility.....	Antifreeze, windshield wash solution, water
Wetted Parts.....	Fiberglass reinforced thermo-plastic, polyurethane rubber, viton, brass, stainless steel

INSTALLATION

Connect the control valve inlet swivel to the fluid supply hose **using sealer**.

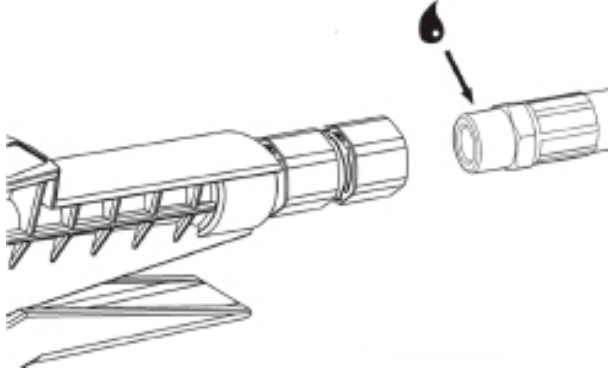

OPERATION

Open the tip, and squeeze trigger to allow fluid to flow. When dispensing is complete, release the trigger, and close the tip.

TROUBLESHOOTING

Symptom	Possible Cause	Remedy
Fluid leaking from outlet in closed position	Debris in valve seat	Clean the valve
Reduced flow	Obstructed inlet filter	Clean the inlet filter

PARTS LIST

Item	Description	Part Number
1	1/4 Turn manual tip	3332-096
2	Flex 90 extension (includes tip)	3332-092
3	Inlet adapter	833535

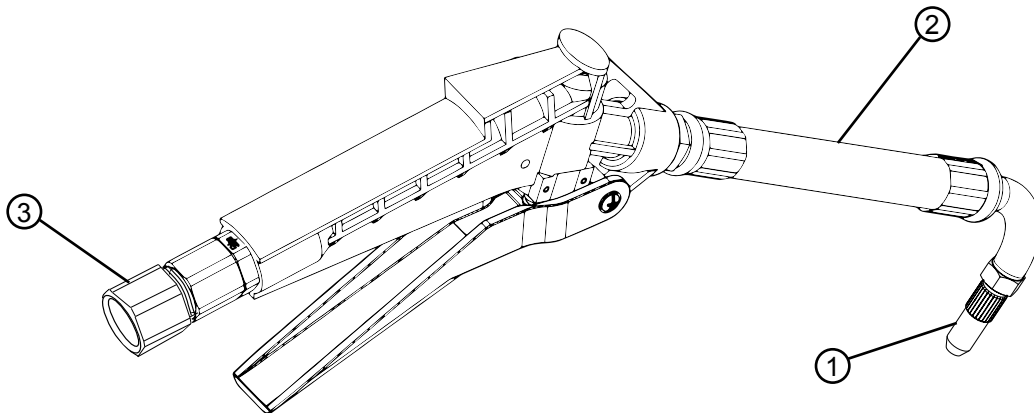

**For Warranty Information Visit
www.balcrank.com**

Balcrank® Corporation
Weaverville, NC 28787
800-747-5300
800-763-0840 Fax
www.balcrank.com

Revision Log:

Rev. A - Release

SERVICE BULLETIN SB3105
Rev. A 04/16