

Balcrank[®]

LION HP[®] STUB PUMP BULK GREASE DISPENSING OUTFIT MODEL #1151-022

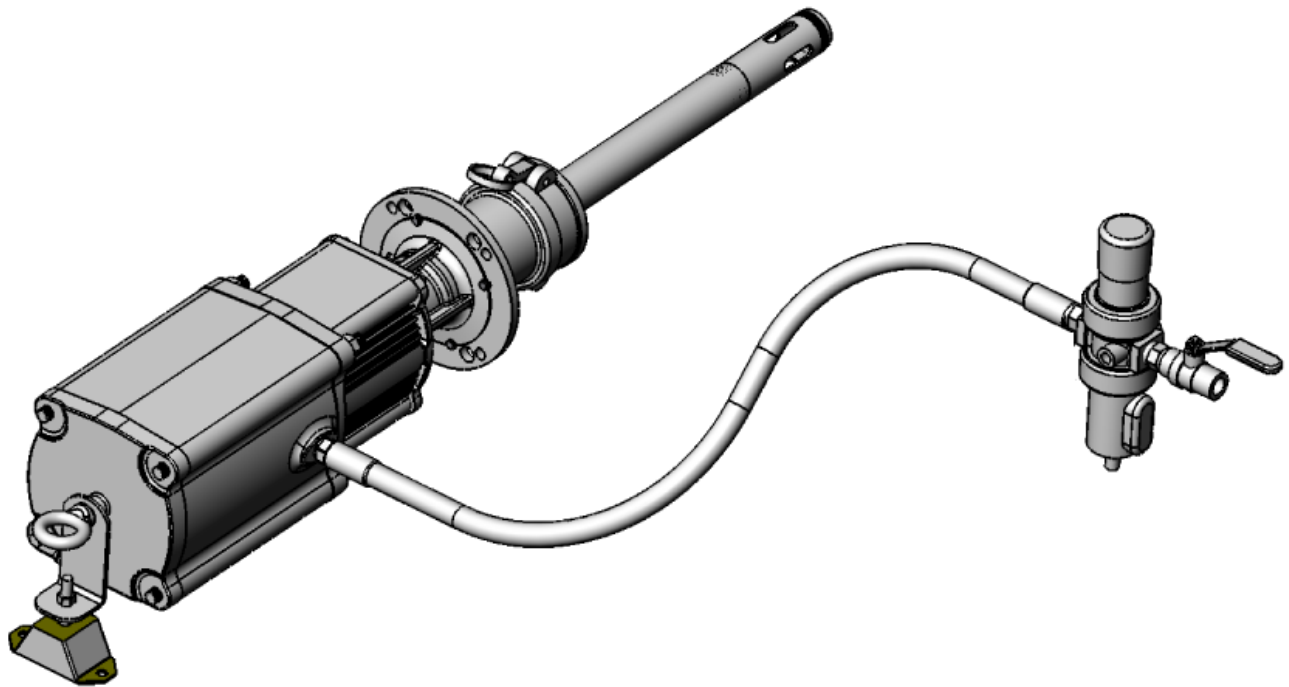



Thoroughly read and understand this manual before installing, operating or servicing this equipment.

**OPERATION, INSTALLATION,
MAINTENANCE AND REPAIR GUIDE**

General Safety

Thoroughly read and understand this manual and the pump manual before installing, operating or servicing the described products.

 **CAUTION:** Always read and follow grease manufacturers' recommendations regarding proper use of protective eye wear, clothing and respirators.

	WARNING
<p>The Lion HP® 50:1 pump (1150-018) develops 7500 psi (517 Bar) maximum working pressure at 150 psi (10.3 Bar) maximum inlet air pressure and stall conditions. Be sure that any components or accessories used in the system are rated to withstand this pressure. To estimate fluid output pressure at stall conditions, multiply the ratio of the pump by the air pressure being used.</p> <p>EXAMPLE: 50:1 Pump Ratio x 100 psi air pressure = 5000 psi fluid pressure at stall.</p>	

Installation

1. Remove pump from box & move into position. Remove the white cap from the end of the discharge pipe of the GOLD Flexi-Bag. Confirm that the gasket between the cap and the discharge pipe was removed with the cap. Locate the black plastic coupling adapter that was provided with the GOLD Dispensing Unit. Confirm that a gasket is in place inside the threaded end of this adapter, and affix it to the threaded end of the discharge pipe. Insert the pump tube through the adapter and into the discharge pipe until the coupling on the pump mates with the adapter. With the lever arms of the coupler clamp positioned as shown in Figure 1, snap the lever arms shut. Looking at the end cap of the pump, the fluid outlet should be positioned to the left and the air inlet should be positioned to the right.

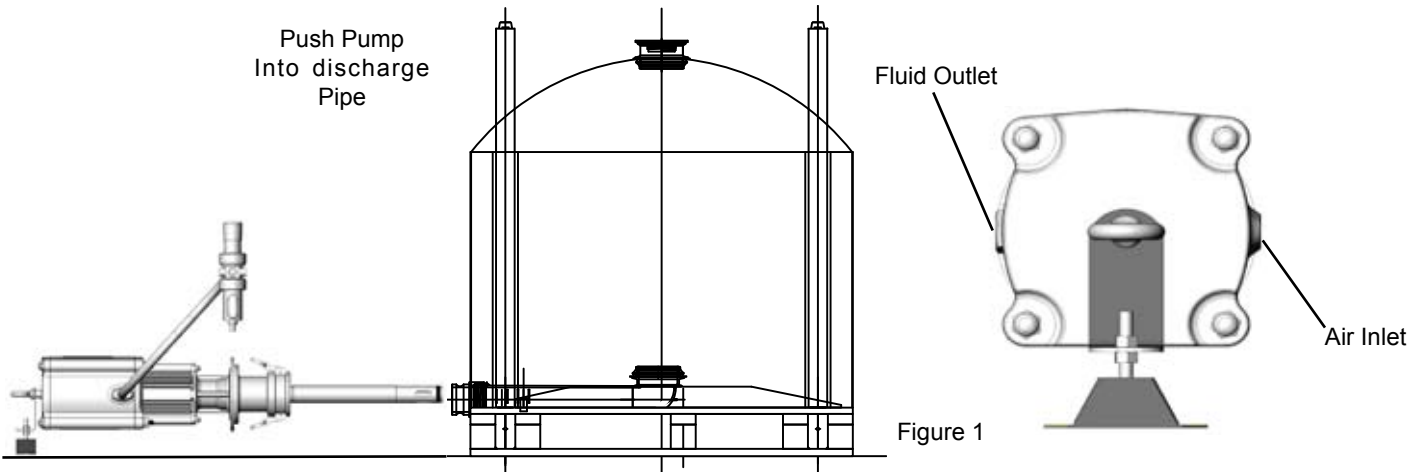

2. If needed, loosen Lifting Eye on pump cap 1/4 turn to reposition side support (item 8). Re-tighten to 40 ft-lbs. To adjust height of side support, loosen nuts on the side support assembly to extend support foot to suitable position, then re-tighten nuts.

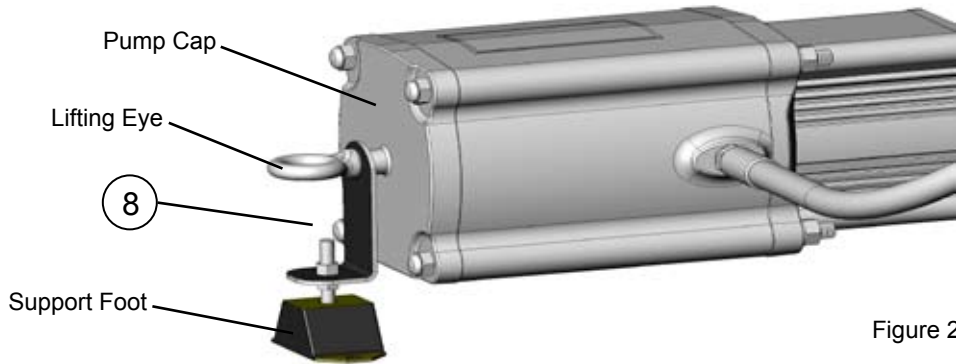

Note: Use appropriate pipe sealant such as teflon tape on all threaded connections in steps 3 & 4.

- 3. Mount Filter-Regulator/Lubricator (FR/L) onto convenient fixed location near pump. Attach air hose provided by customer from FR/L to pump as shown in figure 3.
- 4. Attach customer provided outlet hose to the grease output port of the pump.

Parts List

LION HP® Stub Pump Outfit Model #1151-022

Item	Part Number	Description	Qty
1	1150-018	Pump, Lion HP, Tote Stub	1
2	832161	Coupler	1
3	832162	Seal, Coupler	1
4	805824	Screw, 3/8-16 x 1"	4
5	3260-036	F/R, Autodrain, 1/2"	1
6	3230-004	Ball Valve, 1/2"	1
7	3270-043	Hex Nipple, 1/2", NPT	2
8	832258	Side Support Assembly	1

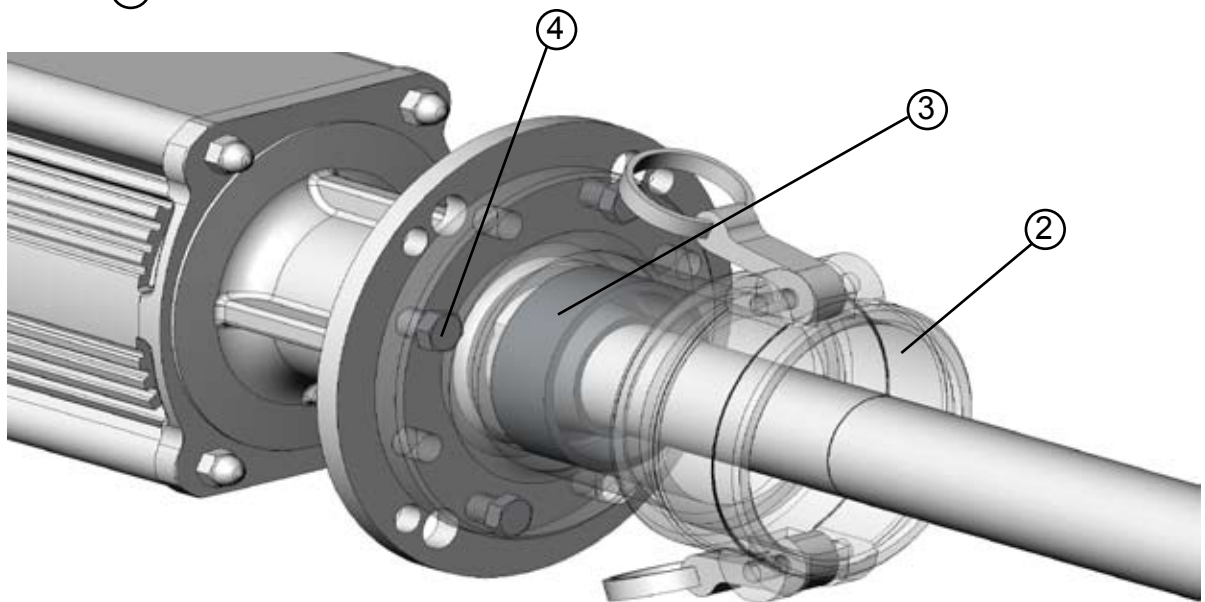
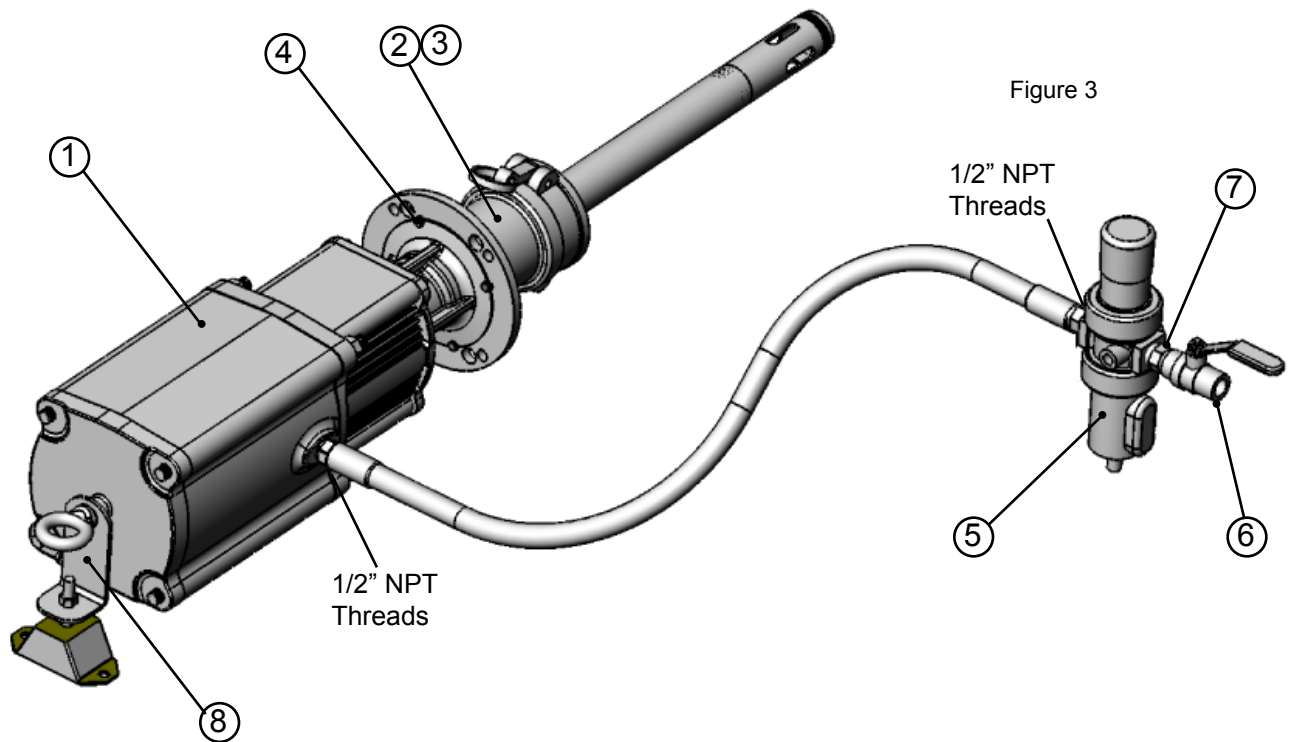

**For Warranty Information Visit
www.balcrank.com**

Balcrank® Corporation
Weaverville, NC 28787
800-747-5300
800-763-0840 Fax
www.balcrank.com

Revision Log:

Rev. A - Release
Rev. B - Corrected part number for item 5 on page 3 and
updated warranty information

SERVICE BULLETIN SB1084
Revision B 11/14