

Balcrank®

CLASSIC PISTOL GRIP CONTROL HANDLE

Quarts

Model #3330-008
Straight Extension

3330-009
Flex Extension

3330-010*
Straight Extension

*(compatible with Antifreeze)

3330-051 Handle Only

Liters

3330-017
Straight Extension

3330-019
Flex Extension

3330-141
Flex 90 Extension

3330-052 Handle Only

Pints

3330-140
Flex 90 Extension



Thoroughly read and understand this manual before installing, operating or servicing this equipment.

**OPERATION, INSTALLATION,
MAINTENANCE AND REPAIR GUIDE**

GENERAL SAFETY



Caution:

- 1) Always read and follow the fluid manufacturers's recommendations regarding the use of protective eye wear, clothing, gloves, and other personal equipment.
- 2) Never alter or modify any parts of this product; doing so may cause damage and/or personal injury.



IMPORTANT

Read these safety warnings and instructions in this manual completely, before installation and start up of the control handle. It is the responsibility of the purchaser

to retain this manual for reference. Failure to comply with the recommendations stated in this manual will damage the control handle and void factory warranty.



WARNING

DANGER: Not for use with fluids that have a flash point below 100°F (38°C, examples: gasoline, alcohol). Sparking could result in an explosion which could result in death.



WARNING

Always use the following Pressure Relief Procedure whenever shutting off, cleaning, or in any way checking or servicing the control handle:

- 1) Disconnect compressed air line or turn off power supply at the fluid pump.
- 2) Point the control handle outlet into a waste container and open trigger to relieve pressure.
- 3) Open any bleed-type supply air valves and fluid drain valves in the system.
- 4) Leave the drain valves open until you are ready to re-pressurize the system.



WARNING

Do not place your hand or fingers over the dispensing nozzle and/or aim the nozzle at a person at any time. Personal injury may result.



WARNING

Airborne particles and loud noise hazards.

Wear ear and eye protection.

TROUBLESHOOTING GUIDE

TROUBLE	CAUSE	REMEDY
No fluid passing through the meter	A. Blocked strainer B. Dirt particles jamming the rotors C. Damaged plunger seal	A. Clean or replace strainer (27) B. Dismantle meter assembly and clean C. Replace damaged plunger seal (25)
Constant oil leak from the tip	Damaged plunger seal	Replace plunger seal (check for damage)
Intermittent drip from the tip	Dirt in the tip Tip not closed (semi-auto tip)	Remove the tip and blow out any dirt particles, replace if necessary Tip must be manually closed
Oil leak from the lever assembly area	Damaged quad rings	Replace damaged quad rings (item 22)
Low flow rate	Blocked strainer	Replace strainer (item 27)
Oil leaking from the swivel inlet	Damaged o-ring or swivel	Replace o-ring (item 34) or swivel (item 36)

EXTENSIONS

ITEM	MODEL	DESCRIPTION
1	3332-019	Flex 90
2	3332-024	Straight
3	3332-067	Flex



3332-085 - AUTO-LOCK TIP

PARTS LIST & DIAGRAM

Item	Description	Dial Capacity		
		4-16 Quart	4-10 liter	1-16 Gallons
		Gallons	Liters	Gallons
1	Shroud Protector			
2	Shroud	820721	820721	820721
3	Screw, Shroud	820753	820753	820753
4	Knob, Reset	820730	820730	820730
5	Pointer, Inner Circle	800194	800194	800194
6	Dial Assembly	829008	800125	
7	Spring, Clutch Roller	800141	800141	800141
8	Clutch Roller	800169	800169	800169
9	Cam, ICP	800192	800192	800192
10	Gear, Register Drive			
11	Gear, ICP	800193		
12	Worm, UDP	820746	800099	820745
13	Setscrew, Worm	820731	820731	820731
14	Spacer	820725	820725	820725
15	Totalizer	820740	800138	820740
16	Nut, Packing Gland	800097	800097	800097
17	O-Ring, Buna N			
18	Washer, Buna N			
19	Packing Gland Kit, Buna N	819564	819564	819564
20	Screw, Sems Type	820752	820752	820752
21	Cam	820715	820715	820715
22	Quad Ring, Buna N	816263	816263	816263
23	Trigger Assembly	820714	820714	820714
24	Sleeve, Valve	820010	820010	820010
25	Valve and Seat, Buna N	825062	825062	825062
26	Spring, Valve	816265	816265	816265
27	Screen	827661	827661	827661
28	Retainer	816266	816266	816266
29	Spindle, UDP	816271	816271	816271
30	Gear Train Assembly			
31	Chamber Complete	816274	820764	816274
32	O-Ring, Buna N	820754	820754	820754
33	Housing Cap	820728	820728	820728
34	O-Ring, Buna N	825065	825065	825065
34	O-Ring, Viton A	825066	825066	825066
35A	Adapter with Boss, NPT	825067	825067	825067
36	Swivel (not shown)	833034	833034	833034

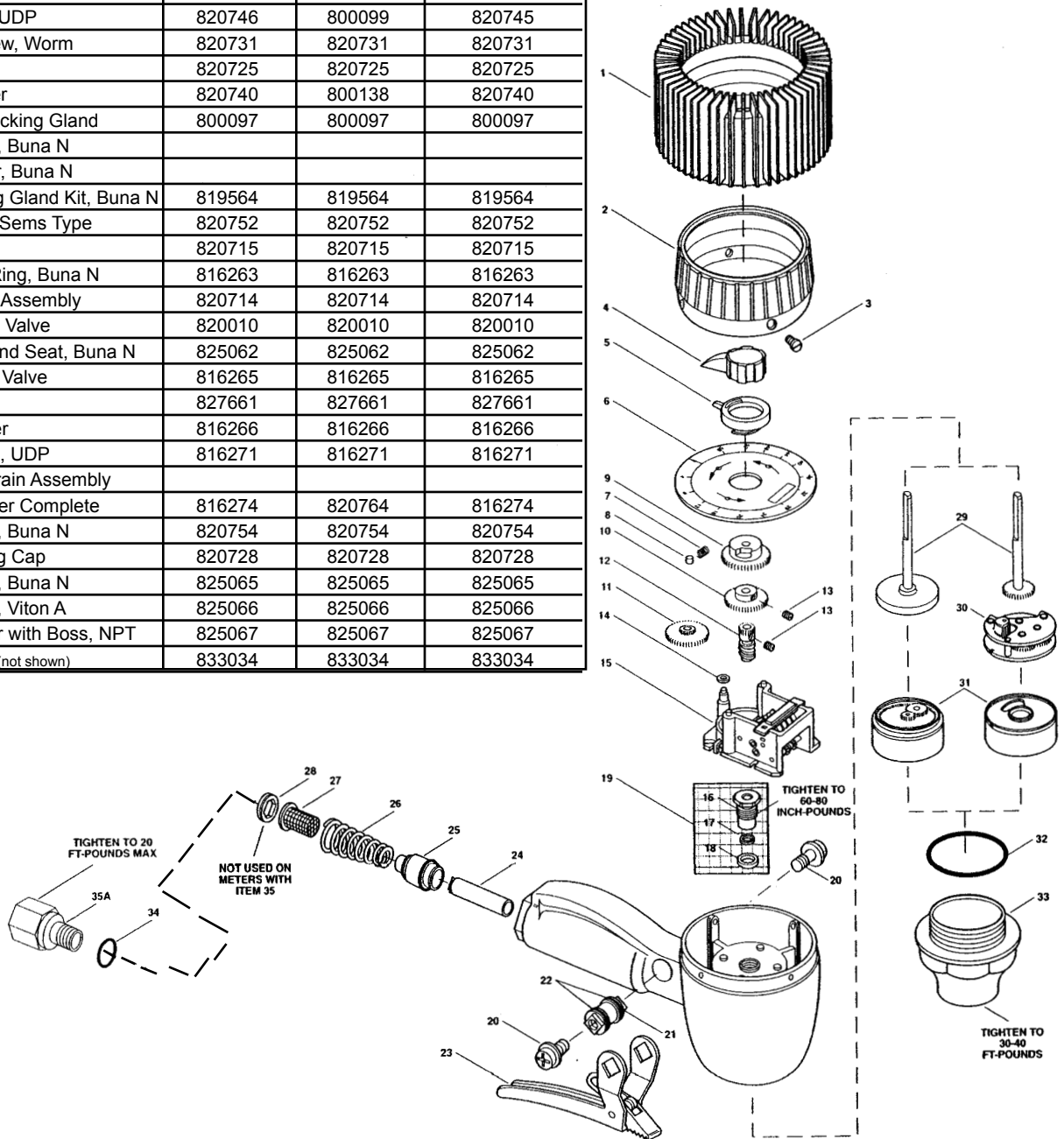

**For Warranty Information Visit:
www.balcrank.com**

Balcrank Corporation
Weaverville, NC 28787
800-747-5300
800-763-0840 Fax
www.balcrank.com

Revision Log:

Rev. B - Added Semi-auto tip.
Rev. C - Added Model #3330-089
Rev. D - Revised item 36
Rev. E - Revised item 36
Rev. F - Removed gear oil models and revised extensions
Rev G - Revised part number for item 36

SERVICE BULLETIN SB3025
Rev. G 8/11