



Used Oil Evacuation Kit

Model 4140-015 **Used Oil Evacuation Kit for 1" Diaphragm Pump**
Model 4140-026 **Used Oil Evacuation Kit for 3/4" Diaphragm Pump**

PRODUCT DESCRIPTION:

The model 4140-015 is for use with the Balcrank® 1" diaphragm pump model 1120-013S (purchased separately) and the model 4140-026 is for use with the 3/4" diaphragm pump model 1120-019 (purchased separately) both are an efficient system for the evacuation of used oil from rolling oil drains to above ground used oil storage.

The evacuated used oil is pumped to used oil storage through a central piping system. A complete listing of components is shown in the illustration inside this bulletin.

INSTALLATION AND ASSEMBLY:



CAUTION

Properly ground the pump and all equipment in the pump area. Static electricity generated by fluid flowing through the pump and its accessories may cause a fire or explosion. Follow your local electrical code for grounding.

1. Installation of control valve assembly:
 - A. Unpack the carton containing the USED OIL Evacuation Kit. (**NOTE:** You must provide fasteners for securing the pump mounting bracket to the surface on which it will be mounted.)
 - B. Drill and tap or install wall anchors as is appropriate for your mounting.
 - C. Install bracket oriented as illustrated on this form.

2. Mounting the pump.
 - A. Unpack the carton containing pump Model 1120-013S or 1120-019. Screw the muffler only hand tight into the exhaust port of the pump.
 - B. Using the 1/4" screws, nuts, and washers supplied with this kit, attach pump to the wall bracket with pump in an upright position and in the orientation shown in the illustration.
3. Attaching the accessories to the pump. (**NOTE:** Use thread tape, on all threaded joints.)
 - A. Attach swivel 3270-050 and the air hose 8134-005, to the air inlet of pump.
 - B. Attach regulator 3260-035, adapter 813182 and ball valve 3230-006 to the free end of the air hose, as shown in the diagram.
 - C. Attach bushing 3270-054 to the pump inlet port and swivel 3270-048 to the pump outlet port (only for model 1120-013).
 - D. For model 4140-015, attach suction hose 8261-005 to the 1" bushing. Attach discharge hose 8261-003 to the 1" swivel. For model 4140-026, attach suction hose directly to the intake of the pump and discharge hose 8264-003 to the pump outlet.
 - E. Attach a dry-break coupler (not included) to the free end of suction hose 8261-005.

NOTE: The customer supplies the following piping connections:

1. Air line to the ball valve 3230-006.
2. Used oil line from the pump discharge hose to the above ground used oil tank.

SYSTEM OPERATION:

1. Close the air regulator by turning the knob counterclockwise.
2. Open ball valve 3230-006 fully.
3. Slowly open the air regulator until the pump begins to cycle. Run the pump slowly initially and gradually open the air regulator until a good suction is achieved.
4. Upon completion of oil evacuation, close ball valve 3230-006 to stop the pump.
5. Check all connections for air or oil leaks and correct where necessary.
6. For all subsequent operations, run the system only by opening and closing ball valve 3230-006.

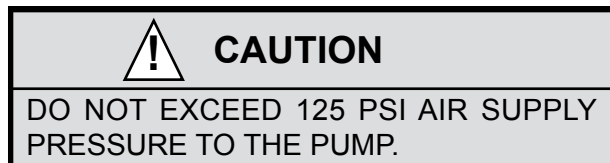

NOTE: USE DRY COMPRESSED AIR. When operating the pump for prolonged periods of time, water in the air may cause ice buildup in the pump air muffler resulting in reduced pump performance.

PREVENTATIVE MAINTENANCE:

1. Hoses: Periodically check the air and used oil hoses for leaks, cuts, or abrasions. Replace any damaged hoses with equivalent pressure rated hose assemblies.
2. Air Muffler: Periodically remove and examine the wire strainer. Clean and replace. A reduced pump performance may result from a dirty strainer.
3. Re-torque all bolts on diaphragm pump. For model 1120-013S torque specifications see SB1096. For model 1120-019 torque specifications see SB1051.

CORRECTIVE MAINTENANCE:

If the pump fails to prime after cycling for 1-2 minutes, shut off the air supply. Before performing any corrective maintenance, refer to the maintenance instruction sheet included with the pump. No other component of the USED OIL Evacuation Kit should require corrective maintenance.

In the event a component is damaged or lost, replacements are available through your nearest Authorized Balcrank® Service Center.

PARTS LIST

			4140-015	4140-026
ITEM	PART#	DESCRIPTION	QTY	QTY
1	4411-016	Bracket, Pump Wall	1	1
2	812570	Screw, Hex 1/4 - 20	4	4
3	806613	Washer, Standard, 1/4"	4	4
4	813561	Nut, Hex, 1/4 - 20	4	4
5	805784	Washer, Lock, 1/4"	4	4
6	3270-050	Swivel		1
	806534	Bushing 3/8" FPT x 1/2" NPT	1	
7	8134-005	Hose 3/8" x 5'	1	1
8	3260-035	Regulator, Air, 3/8"	1	1
9	813182	Adapter, 3/8" x 3/8"	1	1
10	3230-006	Valve 3/8"	1	1
11	3270-054	Bushing 3/4" x 1"	1	
12	3270-048	Swivel	1	
13	8261-005	Hose, 3/4" x 5'	1	1
14	8261-003	Hose, 3/4" x 3'	1	
14	8264-003	Hose, 3/4" x 3' w/male swivel		1

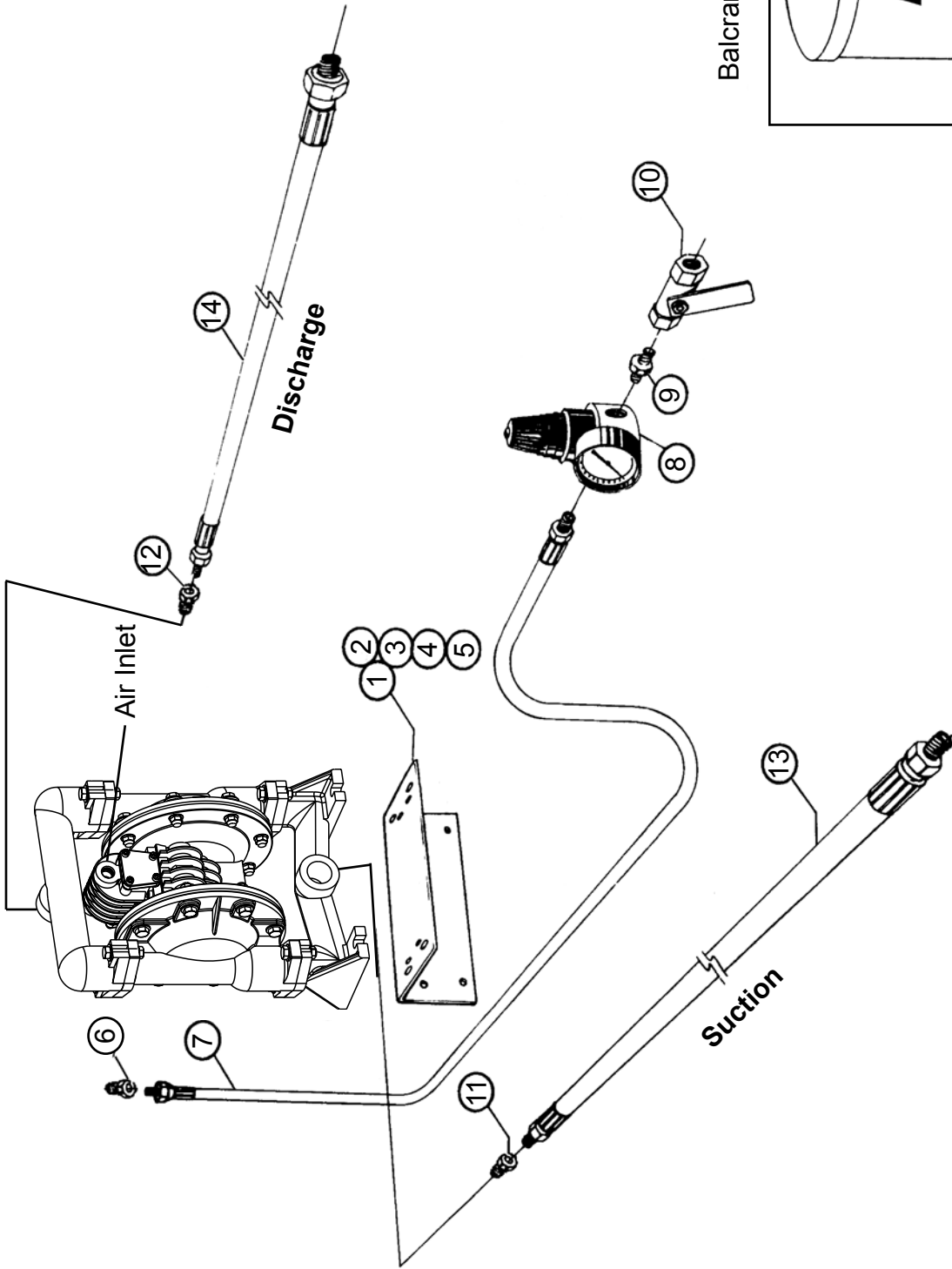

Balcrank Rolling Oil Drain

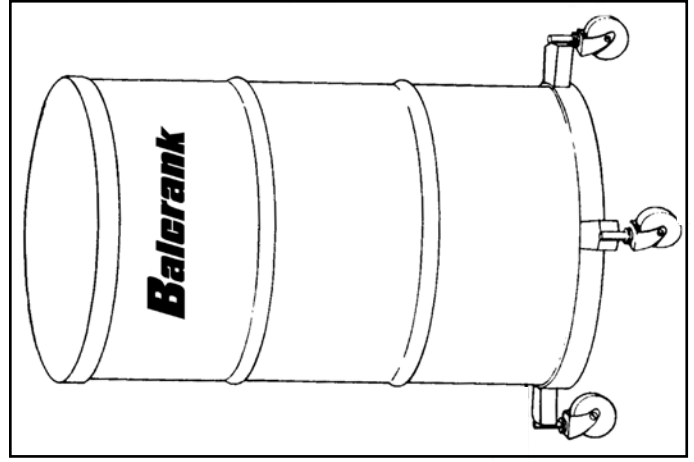

**For Warranty Information Visit:
www.balcrank.com**

Balcrank® Corporation
Weaverville, NC 28787
800-747-5300
800-763-0840 (Fax)
www.balcrank.com

Revision Log:
Rev. H - Added model 4140-026
Rev. I - Changed part number for items 1, 7, 11, &
removed item 15 (dry-break coupler) from
parts list. Removed model 4140-015D

SERVICE BULLETIN SB4080
Rev I 04/14