



Oil Refill Pump Kit

Model 1121-004.....Refill Pump Kit



Thoroughly read and understand this manual before installing, operating or servicing described equipment.

Description & Specifications

Model 1121-004 Refill Kit is configured for use as an accessory for Castrol Booster Oil Cart products, Balcrank models 1131-017 and 1131-018. It includes an air diaphragm pump for transfer of oil from a drum or bulk container to the cart, a tank bung adapter kit for the pump, an air filter-regulator, an air hose and quick coupler, and an oil transfer hose.

Intended Use:

This product is designed and intended for transfer of Castrol Syntec and other Castrol lubricating oils only, from bulk tanks or drums to a Castrol Booster Cart. It may be used in any clean workshop environment.

Oil Pump:

Air operated Model 1120-011 ratio 1:1, air pressure range 0-100 psi. Maximum air consumption 20 SCFM (15-18 SCFM normal working requirement).

Operating Temperature Range:

32-125 Degrees F.

Compatible Fluids:

Intended for use with Castrol Syntec and other Castrol lubricating oils only.

Wetted Parts:

Aluminum alloy, Buna, Carbon Steel, Polypropylene.

Oil Flow Rate:

5 to 9 GPM using 80-100 psi air pressure. Regulate air line pressure to 80-100 psi.

Equipment Set-up

1) Remove the air diaphragm pump and other components from the shipping box.

2) Locate the air inlet port on the diaphragm pump [1]. Install the following parts, in sequential order, at the air inlet port location: 1/4" close nipple [7], air filter-regulator [2], air nipple [6], air coupler [5], air hose [4]. Use pipe thread sealant and turn all fittings tight.

3) Locate the oil output port on the diaphragm pump [1]. At that port, attach the oil hose [3]. Use pipe thread sealant and turn all fittings tight.

4) On the other end of the oil hose, install the dry-break coupler half which has been supplied with the Castrol Oil Cart.

5) Drop the completed refill pump assembly into the oil supply drum or bulk tank. Turn the pump adapter mounting threads into the bung fitting of the tank until tight and secure.

6) Close the air shutoff valve on the air diaphragm pump.

7) Connect the open end of the air hose [4] to a shop air supply, then set the air regulator [2] to 80-100 psi. Place the open end of the oil hose [3] in an oil return opening on the drum or reservoir and operate the pump by opening the shutoff valve next to the pump air inlet port. Operate the pump for a short duration until priming occurs, then shut off the valve to stop flow.

8) The pump system is ready for use. See the next section for description of a refill operation. Disconnect the air hose [4] at the quick-coupler [5] if the pump will not be used immediately.

Operation

- 1) Position the Oil Booster Cart adjacent to the bulk refill container and lock the caster brakes on the cart.
- 2) Using a clean shop rag, wipe the dry break fitting clean. Connect the oil hose [3] to the cart at the dry-break connection.
- 3) Close the shutoff valve on the air diaphragm pump [1]. Connect the air hose [4] on the refill pump to its air supply line. Be sure air to the diaphragm pump is set to 80-100 psi.
- 4) Open the diaphragm pump [1] shutoff valve to begin transferring oil. Observe the oil level gauge on the Cart reservoir as its oil level rises. **Do not fill the cart unattended.**
- 5) Close the shutoff valve when the oil level gauge indicates a full reservoir level. **Do not overfill.**
- 6) Disconnect the dry break coupling and store the oil hose.
- 7) Disconnect the air hose [4] at the diaphragm pump, unlock the caster wheels, then move the cart to its dispensing location.

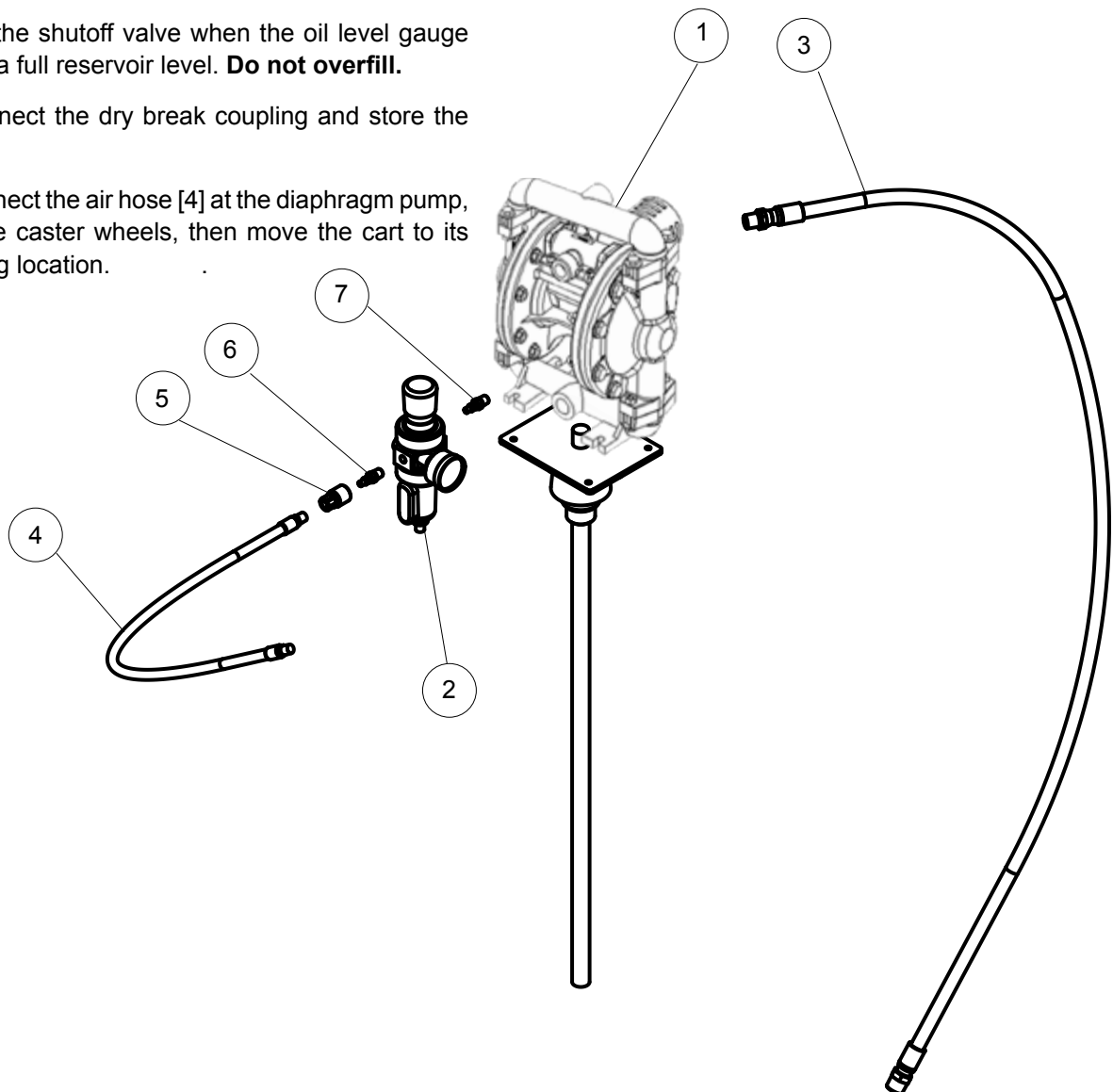

Parts List

Item	Qty	Part No	Description
1	1	1121-002	Bung Mount Pump Kit
2	1	3260-034	Air Filter Regulator
3	1	830105	Hose, med Pres, .500" ID x 10 ft.
4	1	8121-005	Hose, Air, .312 ID x 5 ft.
5	1	811750	Air Quick Coupler
6	1	813462	Air Nipple
7	1	806671	Pipe Close Nipple 1/4 NPT

Balcrank Lubrication Equipment Warranty Statement

All Balcrank equipment sold by authorized Balcrank distributors is warranted to their original customer to be free from defects in materials and workmanship for a period of one year from the date of sale to that customer. Selected Balcrank equipment carries warranty terms for a more extended period as defined in the Balcrank Lubrication Equipment & Accessories User Price List, wherein a "lifetime" warranty represents a warranty period of thirty years. Within the initial one-year warranty period, Balcrank will repair or replace all Balcrank equipment determined by Balcrank to have defective materials or workmanship. For equipment carrying more extended warranties, Balcrank will repair or replace the product including parts and labor during the first full year and will provide parts only for the remainder of the warranty period.

This warranty applies only to equipment installed and operated according to applicable Balcrank Service Bulletins and Installation Instructions.

Any equipment claimed to be defective must be returned, freight prepaid, to an Authorized Balcrank Service Center (ASC). Upon receiving candidate warranty equipment from a customer, ASC will: 1) diagnose to determine the warrantable condition of the equipment, 2) submit, prior to repair or replacement, a request to Balcrank for warranty authorization, then 3) in cooperation with Balcrank, proceed with repair locally or forward the equipment to Balcrank and obtain replacement. If the part(s) or equipment items are found defective upon inspection by Balcrank, they will be repaired or replaced, and then will be returned to the ASC. If Balcrank finds the claimed part(s) or equipment not to be defective, the ASC will receive written authorization from the original customer, and then repair them for a reasonable charge to the customer, which will include all applicable parts, labor, and return transportation costs.

Optionally, the customer may submit certain eligible products directly to Balcrank for warranty return by using Balcrank Lubrication Equipment Direct Service Warranty Procedure. Eligible products are defined in the Balcrank Lubrication Equipment & Accessories User Price List. Refer to the Balcrank web site www.balcrank.com for a copy.

Any equipment returned to Balcrank must have the Warranty Service Claim number (WSC#) clearly marked on the outside of the carton. Balcrank's sole responsibility is for defects in material and workmanship, and Buyer's sole and exclusive remedy hereunder, shall be limited to repair or replacement of the defective part or equipment.

This warranty does not cover, nor shall Balcrank be liable for repair or replacement of parts or equipment resulting from general wear and tear through use, or damage or failure caused by improper installation, abuse, misapplication, abrasion, corrosion, insufficient or improper maintenance, negligence, accident, alteration, or substitution of non-Balcrank parts.

Furthermore, the Warranty for Lubrication Equipment and Accessories does not cover the following specific conditions:

- Failure or damage to equipment caused by dirt or debris in compressed air lines and fluid lines. This includes, but is not limited to, clogged inlet filters, strainers, or regulators; fluid meters; control handles; fluid tips; and valves.
- Failure of normal wear parts including but not limited to: o-rings, packings, seals and valves unless originally improperly installed by the factory.
- Products placed in applications for which their use was not intended. Examples include but are not limited to Lubricant pump being used to pump solvents, or placing equipment intended strictly for indoor use outdoors
- Damage to equipment resulting from operation above and beyond Balcrank's recommendations.
- Leaks at air and fluid fittings and connections.
- Damage caused by thermal expansion whenever adequate pressure relief was not included in the system.
- Loose suction tubes on pumps.
- Incorrect hose reel spring tension, requiring adjustment.

THERE ARE NO OTHER WARRANTIES, EXPRESSED OR IMPLIED, INCLUDING WARRANTIES OF MERCHANTABILITY OR FITNESS FOR A PARTICULAR PURPOSE. IN NO EVENT SHALL BALCRANK BE LIABLE FOR ANY SPECIAL, CONSEQUENTIAL, OR OTHER DAMAGES OF SIMILAR NATURE, INCLUDING BUT NOT LIMITED TO LOST PROFITS, LOST PRODUCTION, PROPERTY DAMAGE, PERSONAL INJURY, WHETHER SUFFERED BY BUYER OR ANY THIRD PARTY, IRRESPECTIVE OF WHETHER CLAIMS OR ACTIONS, LEGAL OR EQUITABLE, FOR SUCH DAMAGES ARE BASED UPON CONTRACTS, WARRANTY, NEGLIGENCE, STRICT LIABILITY, OR OTHERWISE. ANY CLAIM OR ACTION FOR BREACH OF WARRANTY MUST BE BROUGHT WITHIN TWO (2) YEARS FROM THE DATE OF SALE TO THE ORIGINAL CUSTOMER.

Balcrank® Corporation
Weaverville, NC 28787
800-747-5300
800-763-0840 Fax
www.balcrank.com

Distributed by:

Revision Log:
Rev A - Updated warranty statement

SERVICE BULLETIN SB 1042
831726
Rev A 12/08