

Oil Piston Pumps Lion™ 350 - 5:1 Pump

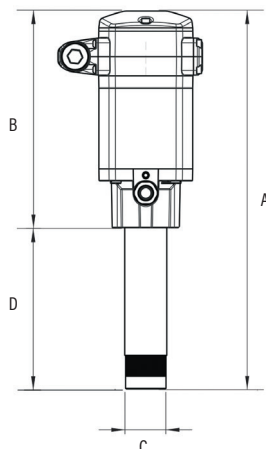

Dimensions inches (MM)			
1430-010			
A	B	C	D
18" (457 mm)	10" (254 mm)	1-1/2" NPT (F)	8" (200 mm)
1430-012			
47" (1194 mm)	39" (991 mm)	1-1/2" NPT (F)	36" (925 mm)

Synthetic and Mineral Based Oils Hydraulic Oil Gear Oil Transmission Fluid

Double-acting, air operated, medium pressure, heavy-duty pumps for dispensing lubricants in medium to large size installations, which may include simultaneous dispense points. Built in port for the included pressure relief valve kit. (3120-214)

Applications

- Railroad and mass transit vehicle maintenance
- Fleet service facilities
- Marine
- Auto and truck dealerships
- Mining and construction
- Lube truck

Pressure relief valve kit included with this pump.

TECHNICAL DATA

Pump ratio	5:1
Operating air pressure	30 to 175 psi (2 to 12 bar)
Air Consumption ⁽¹⁾	12.4 CFM (350 NI/min)
Maximum pressure	170 psi 12 bar
Air motor effective diameter	3.25" (80 mm)
Air motor stroke	3.15" (80 mm)
Delivery at 80 cpm	3.2 gal/min at 100 psi (12 l/min at 5 bar)
Flow rate	8 gal/min (30 l/min)
Air inlet	3/8" NPT (F)
Fluid inlet (stub pump only)	1 1/2" NPT (F)
Fluid outlet	1/2" NPT (F)
Wetted materials	Steel, Hard Chromed Steel, Polyurethane, NBR, Aluminum
Service Bulletin	SB 1155

MODELS AVAILABLE

1430-010

1430-012

DESCRIPTION

Lion™ 350 5:1 Stub Pump Bung

Lion™ 350 5:1 Drum Pump

SAE 10, 70 °F (21 °C) CAPACITY CURVE

